

कुडाळिश्वर  
कृपा

॥ तुमच्या आनंदाचा नवीन पत्ता ॥



कृडाक्षर  
कृपा  
PHASE - I



## Stack Parking

### ADOPT THE PEACE OF *nature*

This project KUDALESHWAR KRUPA is executed by Weaver Constro at Market Area in Kudal district, connected to Kudaleshwar Mandir Wadi Road. This project is as per Vastu compliant. Kudal is a Kudaleshwar town in Sindhudurg district in the Indian state of Maharashtra. There is a railway station at Kudal on the KRCL (Konkan Railway Corporation Ltd.) route connecting the cities of Mumbai and Mangalore. Sindhudurg is India's first district which is reserved for Tourism. Sindhudurg offers immense scope for tourism with virgin beaches, caves, historical forts, old temples, and of course the gorgeous coastline. Sindhudurg has all the ingredients of a tourist spot. With the fulfillment of a long-cherished and much-delayed dream the Konkan Railway, now operational the development has gathered momentum.





TYPICAL FLAT  
NO. 103 TO 603  
**2 BHK**



TYPICAL FLAT  
NO. 102 TO 602  
**2 BHK**

TYPICAL FLAT  
NO. 104 TO 604  
**1 BHK**



TYPICAL FLAT  
NO. 105 TO 605  
**1 BHK**







# TYPICAL FLOOR PLAN

## 1ST TO 6TH FLOOR ( PH-1 )

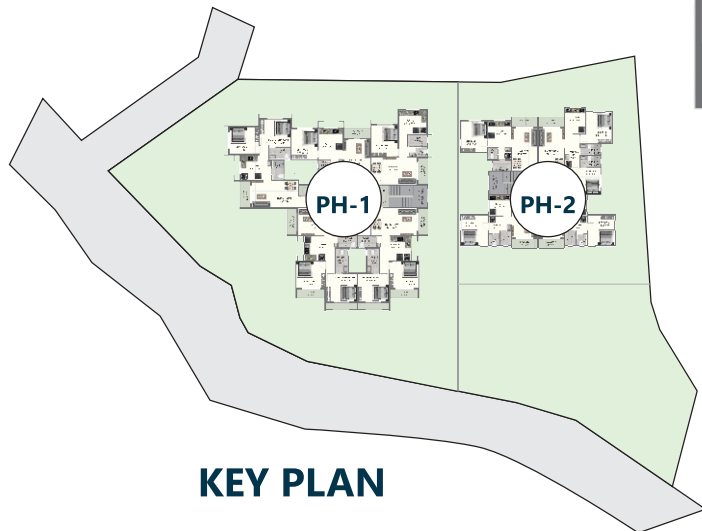

KEY PLAN

### AREA STATEMENT PH-1

Flat No.	Carpet Area	Enclosed Balcony Area	Normal Balcony Area	Total Carpet Area
A-101 to A-601	59.11	0.00	6.88	65.99
A-102 to A-602	59.10	0.00	6.91	66.01
A-103 to A-603	56.26	3.51	3.84	63.61
A-104 to A-604	44.79	0.00	3.56	48.35
A-105 to A-605	45.77	0.00	3.46	49.23



# कुदालेश्वर कृपा

## Kudaleshwar Krupa - Blessed Living Begins Here”

Rooted in the divine presence of Shri Dev Kudaleshwar Temple, this project carries the spirit of grace and peace in every brick, More than just a home,, Kudaleshwar Krupa is where blessings meet lifestyle-offering you not just a space to live, but a sacred connection to tradition,serenity,and daily inspiration.

# FEATURES & AMENITIES



## Structure

- Earthquake Resistant RCC Framed Structure.



## Door

- Decorative Entrance Door • Commercial Flush Door to Bedroom
- Water Proof Ply for Bathroom and Terrace



## Windows

- Powder Coated Aluminium Sliding Windows
- Aluminium Lowers with Provision for Exhaust fan in Toilet



## Flooring

- Verified Tile Flooring in the Entire Flat Except toilet.



## Kitchen

- Telephone Black or Similar Granite for the Kitchen Platform with Stainless Steel Sink and Outlet



## Painting

- Neru Finished Walls
- . Oil Bond Distemper for Internal Walls & waterproof Exterior Paint finish.



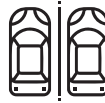

### **Parking**

- Stack Parking

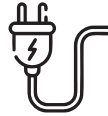

### **Electrification & Cabling**

- Concealed copper wiring in the entire flat.
- Provision of Television & Telephone point.



### **Water Supply**

- 24 Hrs water supply through overhead tank.



### **Lift**

- Lift with ARD (Auto Rescue Device)



### **Power Backup**

- Power backup for all common light and Lift



### **Toilet**

- Concealed plumbing with chromium-plated fittings of exclusive quality.
- Hot and Cold mixer in toilet.
- Colored Glazed Dado Tiles up to 7 feet in the toilet.
- Anti-skid flooring in Bathroom & Toilet.

# A PLACE WHERE PEACE IS *a priority*

Sindhudurg has suddenly caught the fancy of many corporations and individuals alike. The area is the nerve center for future development and a promising belt for the tourism industry. With untapped natural beauty and bounties of nature, an exotic location, white sand beaches, lush greenery, and abundant rainfall, the area will soon surge ahead to become one of the best tourist destinations.



Kudal supports one MIDC area. Kudal railway station is located on the Konkan Railway route and connects the town with Mumbai on the north and Mangalore on the south. It is a major stop for the Konkan Railway with many trains having a halt. The Deccan Odyssey train also stops in Kudal. National Highway 66 passes through Kudal. Apart from that, it also has two bus stations, a new one and an old one. The old one is situated in the market near our project. while the new one is just adjacent to the NH-66.

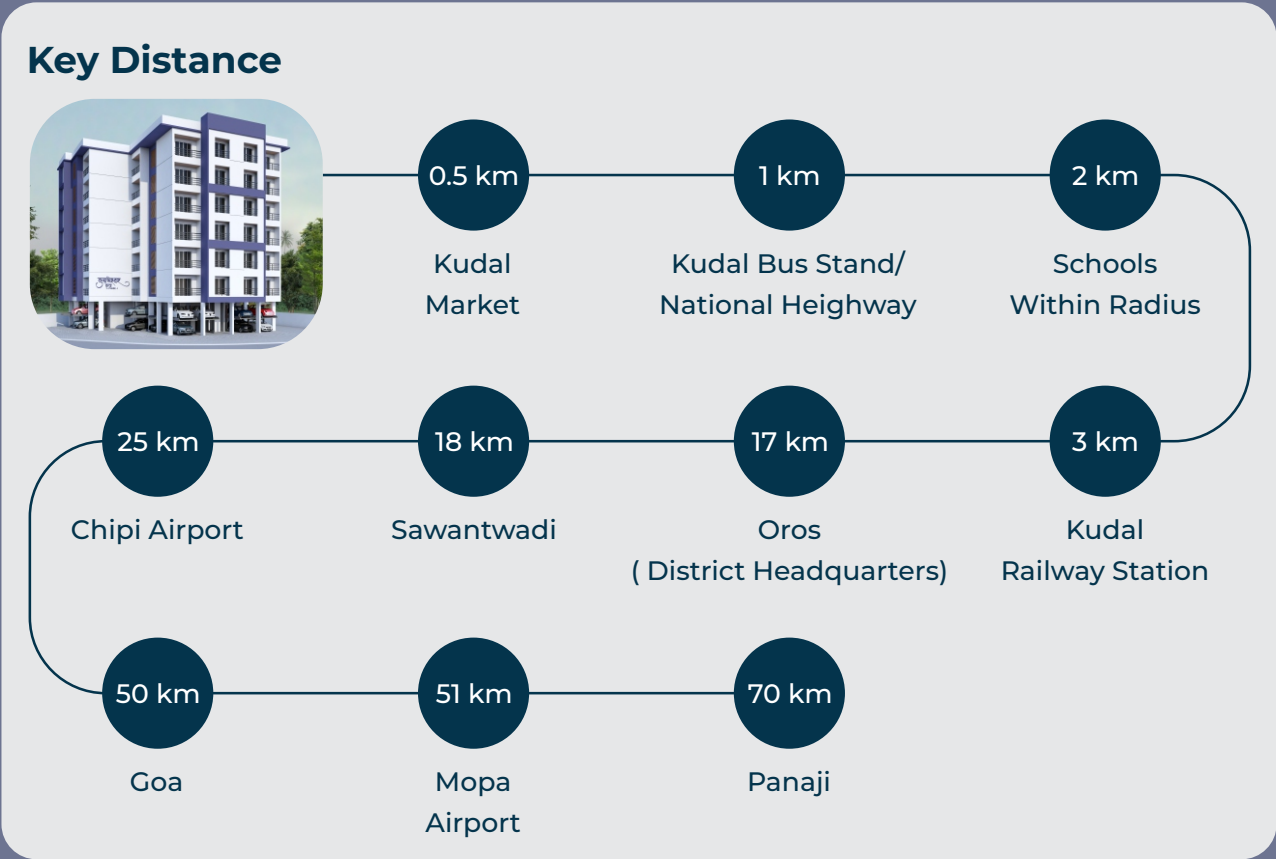

All tourist attractions are Vengurla Beach, Bhogave Beach, Nivati Beach, Kille Nivati Beach, Devbag Beach, Tarkarli Beach, Khavana Beach, and Sindhudurga Fort with a 20-30 Min. range.



# WEAVER CONSTRUCTION

## Presents

### SITE ADDRESS :

Shree Dev Kudaleshwar Mandir Road,  
Near Br. Nath Pai School,  
Kudaleshwarwadi, Tal- Kudal, Dist- Sindhudurg

### OFFICE ADDRESS :

"Kudaleshwar Darshan" Kudaleshwar wadi ,  
Near Shree Kudaleshwar Mandir  
Tal- Kudal, District- Sindhudurg. 416520.

### CONTACT :

**Sagar Teli-+91 9112935333**

 [weaverconstructionkudal@gmail.com](mailto:weaverconstructionkudal@gmail.com)



**Scan QR Code For Site Location**

**Disclaimer:** All images, layouts, plans, and specifications in this brochure are for illustration purposes only and may be subject to change. The information provided is intended to give a general overview of the project and does not form part of any legal contract. The developer reserves the right to make modifications to the project as deemed necessary. Prospective buyers are advised to independently verify all details, including availability, pricing, and amenities, before making any decisions. Terms and conditions apply.